

Thin Stone is an ultra-thin reinforced slab of natural stone, cut down to 1 cm thickness, approximately 3/8" actual. Thin Stone slabs are available in all of Polycor's granites and marbles, each weighing 2/3 less than traditional 3 cm slabs. Available in standard 2cm thickness, and in our exclusive 1cm carbon fiber reinforced thin panels.

STONE TILE - INTERIOR WALL APPLICATION

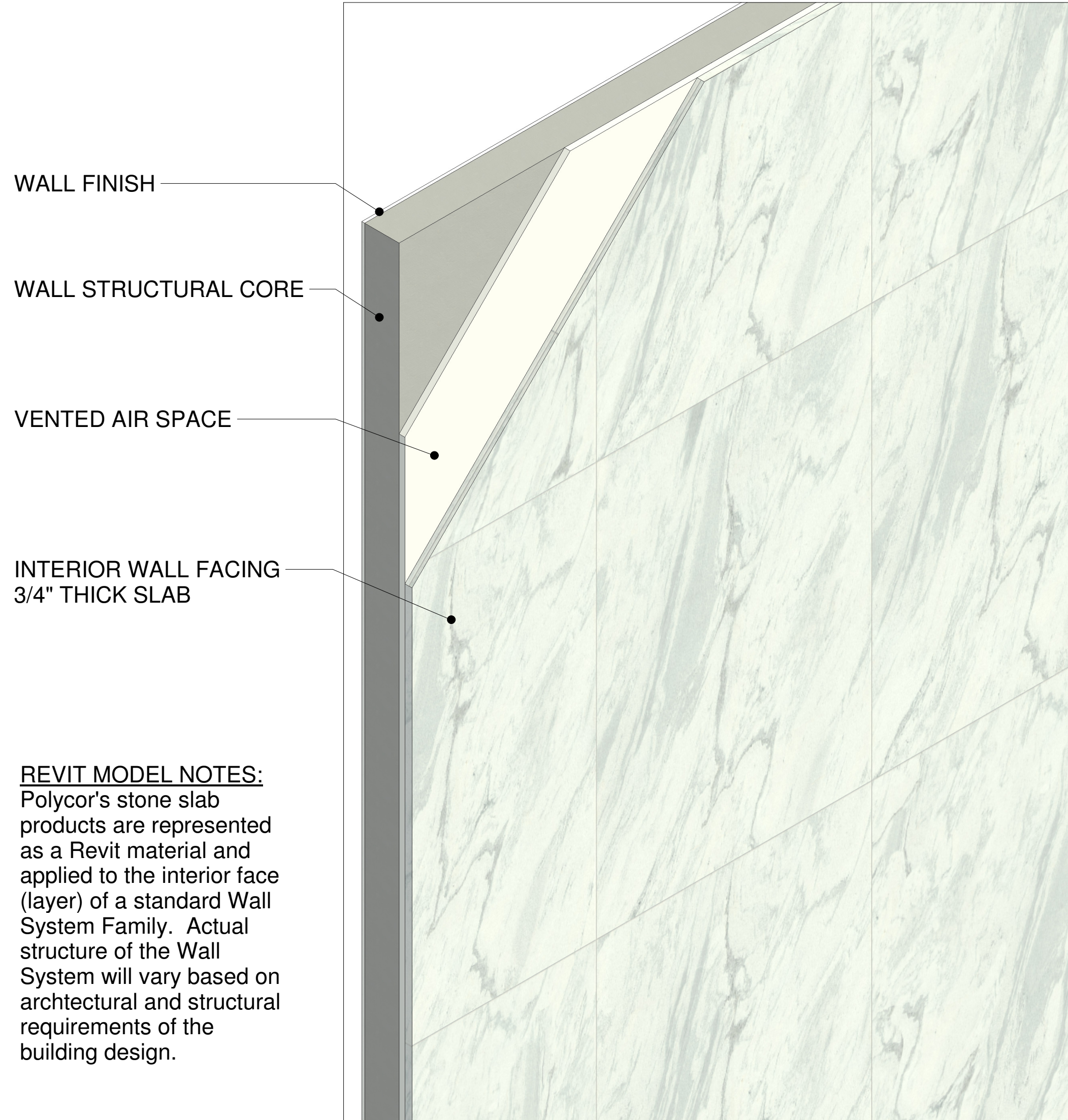

WALL FINISH

WALL STRUCTURAL CORE

VENTED AIR SPACE

INTERIOR WALL FACING
3/4" THICK SLAB

REVIT MODEL NOTES:
Polycor's stone slab products are represented as a Revit material and applied to the interior face (layer) of a standard Wall System Family. Actual structure of the Wall System will vary based on architectural and structural requirements of the building design.

TYPICAL INTERIOR WALL STRUCTURE

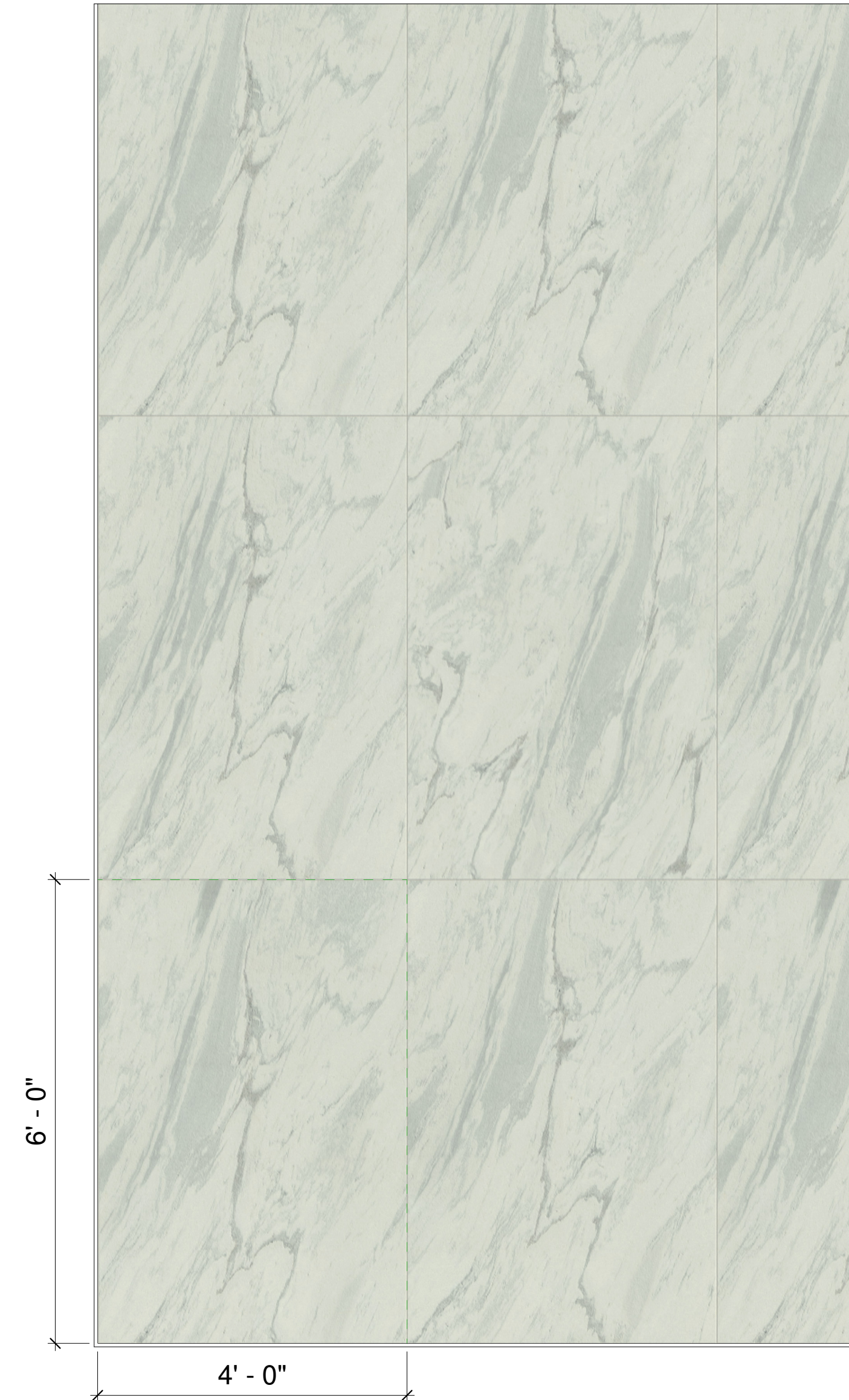

GEORGIA MARBLE™ - PEARL GREY 3/4" THICK
STONE TILE (SLABS)

